

SMD3225 差分晶振 LVPECL

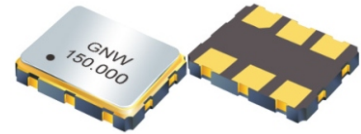

APPLICATIONS

- SONET / SDH / Gbits / Ethernet
- IEEE1394 / Fibre Channel
- Graphics/ Radar/ HD Monitoring Devices

FEATURE

- LVPECL Differential Output
- Wide Frequency Range
- Low Phase Jitter:0.3ps,Typical

- Low Operating Voltage:2.5V/3.3V
- Tri-state Available



Electrical Specifications 电气参数

项目	Item/Type	Electrical Specifications
频率范围	Frequency Range	10MHz to 250MHz
输出	Output	LVPECL
电源电压	Supply Voltage	2.5V,3.3V(±10%)
频率稳定度	Frequency Stability	±25ppm, ±50ppm
工作温度	Operating Temperature Range	-40°C ~ +85°C
消耗电流	Current Consumption	45mA max.
输出负载	Output Load	50Ω(terminus to Vcc-2V)
占空比	Symmetry	45% to 55%
启动时间	Start-up Time	10ms max.
上升/下降时间	Rise/Fall Time	1ns max.
输出电平-高	Output Logic High "1"	1.025V min.
输出电平-低	Output Logic Low "0"	1.620V max.
相位抖动	Phase Jitter	1ps max.@12KHz to 20MHz
储存温度范围	Storage Temperature Range	-55°C ~ +125°C
老化率	Aging (at 25°C)	±3ppm/year max.

Mechanical Dimensions 外型尺寸

Units:mm

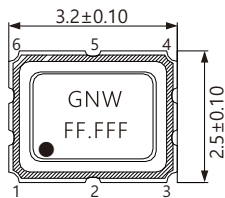

Top View

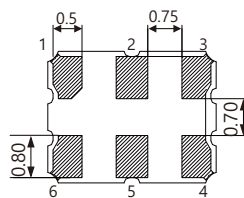

Bottom View

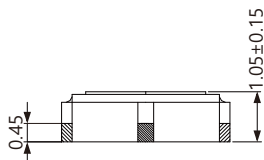

Side View

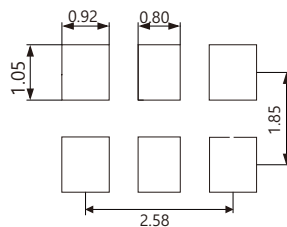

Land Pattern

Terminal	Connection
#1	Tri-state or N.C
#2	N.C
#3	GND
#4	Output
#5	Complementary Output
#6	Vcc

Tri-state Function	
Tri-state pin	Output
High or Floating	Active
Low	Hi-Impedance